

IVC2700

In Vessel Composter



Model no: IVC2700	Part no: F75/010
Description: In Vessel Composter (small)	Features: Processing capacity approx 150 - 300kg food waste (dry) per week.

The IVC2700 enables smaller sized commercial catering establishments to eliminate food waste disposal costs and convert the waste into a valuable resource whilst also caring for the environment in a responsible way.

The IVC2700 recycles mixed catering food waste, that has first been macerated and dewatered, in to a high quality compost at a rate of approx 20 - 50kg compost per tonne of food waste.

Food Waste to Resource



Specification

Model		IVC2700	Connections	
Max Capacity (kg)*		859	To ventilation (mm)	110
Capacity volume (cu m)		1.534	To drainage (mm)	54
Capacity volume (litres)		1,534	Outlet height (mm)	660
No. kgs food waste / day*		27-40	No. of feet	6
No. kgs food waste / week*		150-300	Electrical supply & Operation	
Pellets - weekly max (kg) included in above		30-60	Voltage range	380-415
No. tonnes food waste / annum*		8-16	Phase (5 wire) supply	3 phase
Measurements - IVC			Frequency (Hz)	50
Length (mm)		2,960	Amps (max)	10
Width (mm)		1,080	Decibel (dB) during operation	55
Height (mm)		1,284	Memory stick capacity (Gigabyte, Gb)	1
Weight – empty (kg)		575	Motor – compost cylinder (kW)	0.37
Max weight – full (kg)		1,434	Motor – hopper auger (kW)	0.55
Measurements - hopper			Fan (kW)	0.04
Length (mm)		785	Air Heater (kW)	0.5
Width (mm)		800	Heater blanket - optional (kW)	2
Height (mm)		1,284	Total (kW)	1.46
Loading height (mm)		930	<p>* The above max capacities are an indication only and should be calculated for each individual site. The max capacity of the IVC is influenced by a number of variable factors including but not limited to:-</p> <ul style="list-style-type: none"> - content / mix of food waste - WastePro auger screen type - IVC fill level - IVC drum stir time, dwell time and filling ratio - IVC fan speed - biological process 	
Capacity volume (cu m)		0.052		
Capacity volume (litres)		52		
Capacity (kg)		40		



Technical Specification

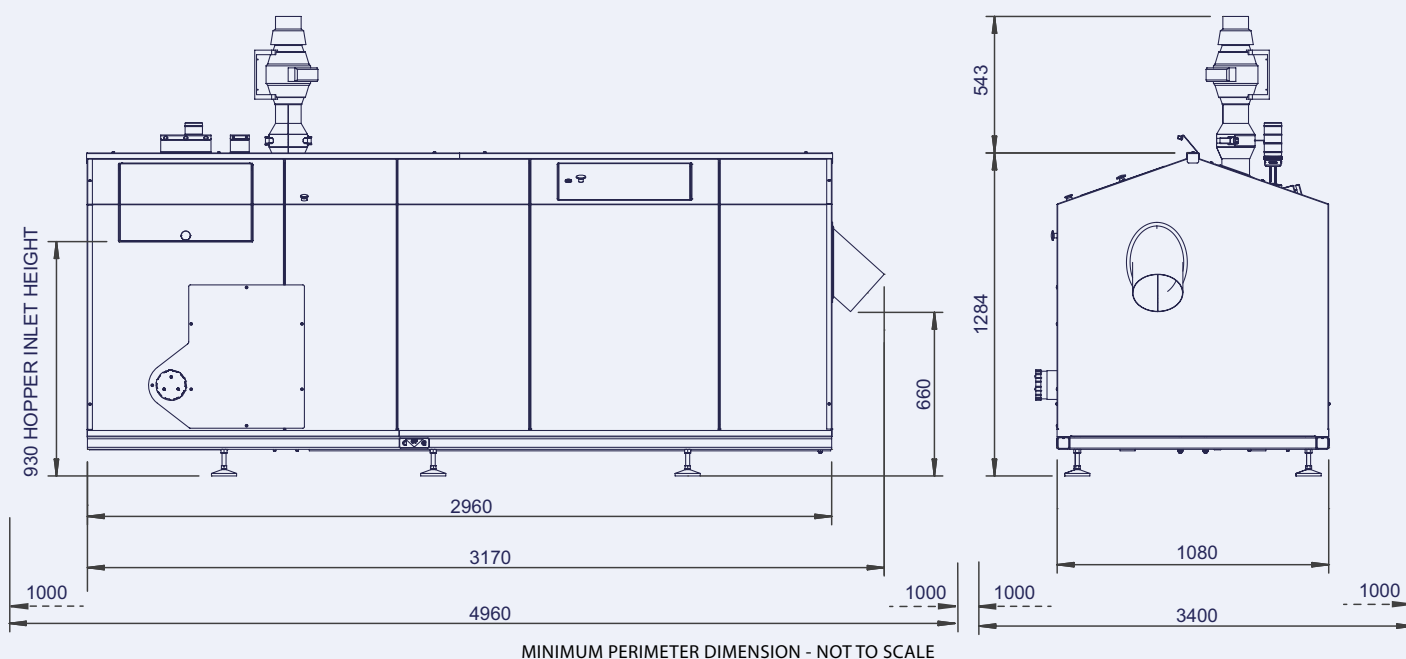

Imperial Machine Company Limited

Unit 1 Abbey Road, Wrexham Industrial Estate
Wrexham LL13 9RF United Kingdom
Tel: +44 (0)1978 661155 Fax: +44 (0)1978 729990
Email: sales@imco.co.uk Web: www.imco.co.uk



Food Waste to Resource

